

Drill 25mm hole at center of door edge.

Fold here and fit on the door edge.

The following requirements should be observed to maintain the finish of your lockset.

- A. Do not install locks before doors are painted.
- B. To avoid oxidation, refrain from using cleansers or acid chemicals to polish or be in contact with locks.
- C. Refrain from using heavy or sharp-edged objects to scrub locks.

**NOTE: FOR DOOR THICKNESS 32-46mm**

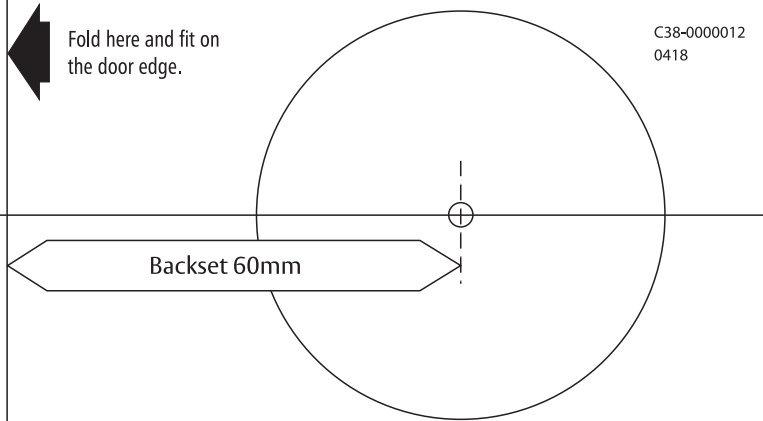
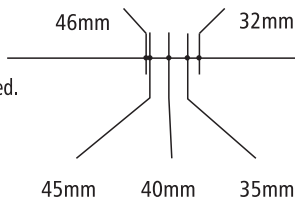

**1 MARK HEIGHT LINE ACROSS EDGE OF DOOR.**

914mm is the usual height from floor. Fold template over edge of door and mark centre at height line. Mark centres of 25mm and 54mm holes.

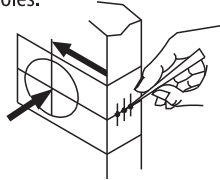

**2 DRILL TWO HOLES**

Drill 54 mm hole through door, and 25mm hole into edge of door on centres marked on template. Chisel out area for latch plate and install 54mm latch unit.

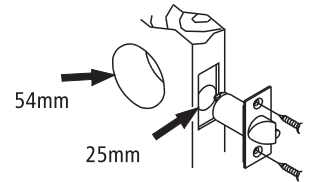

**3 INSTALL STRIKE**

Auxiliary bolt stops against strike, as illustrated, preventing forcing when door is closed.

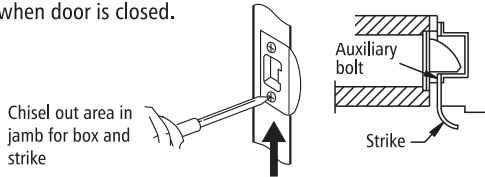

**4 REMOVE INSIDE TRIM**

Use nail end of wrench to depress inside knob catch through hole of sleeve collar and slide inside knob off spindle.

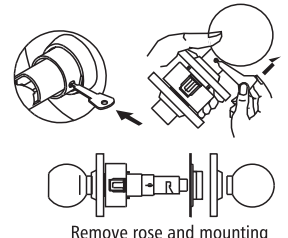

**5 ADJUST FOR DOOR THICKNESS**

Adjust lock to fit door thickness by rotating outside rose. Lock 32mm to 46mm thickness.

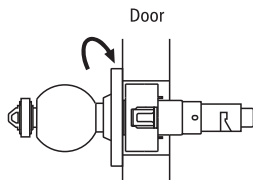

**6 INSTALL LOCK**

Latch unit must be installed before installing lock. Be sure lock housing engages latch prongs and retractor interlocks with latch bar.

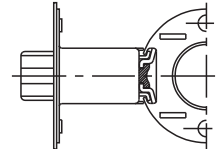

**7 INSTALL INSIDE ROSE**

Install rose by snapping it onto the recess of mounting plate.

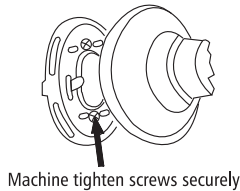

**8 INSTALL KNOB**

Align lug on knob with narrow slot on spindle and push knob all the way in until retainer clicks into slot on knob.

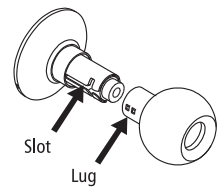

**9 DETERMINE CORRECT KEY HOLE POSITION**

Be sure to install cylinder with key hole opening facing down as illustrated.

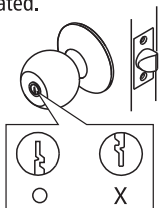

**10 FOLLOW STEPS BELOW TO CORRECT A CYLINDER PLACED IN REVERSE**

- A. First, turn knob clockwise until knob catch appears in small hole.
- B. With other hand, turn key counterclockwise 30-90 degrees.
- C. Use wrench to press knob catch as you pull knob out.
- D. Turn knob 180 degrees so key hole opening faces down and slide knob into spindle to engage knob catch.
- E. Insert key in keyhole and turn key counterclockwise or clockwise about 30 degrees and push knob until it catches. Make sure knob clicks into

