

# Lockwood MTL™800 Restricted Keying



We take the worry out of  
protecting what's valuable to you.  
Lockwood: *no worries*®



ASSA ABLOY

25YEAR  
MECHANICAL  
WARRANTY

[www.lockweb.com.au](http://www.lockweb.com.au)

# Contents

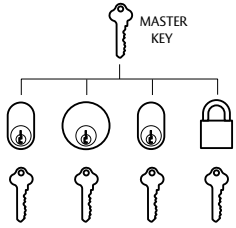

## Master Keying Information

page 3



## Cylinders

page 11



## Modular extensions overview

page 25

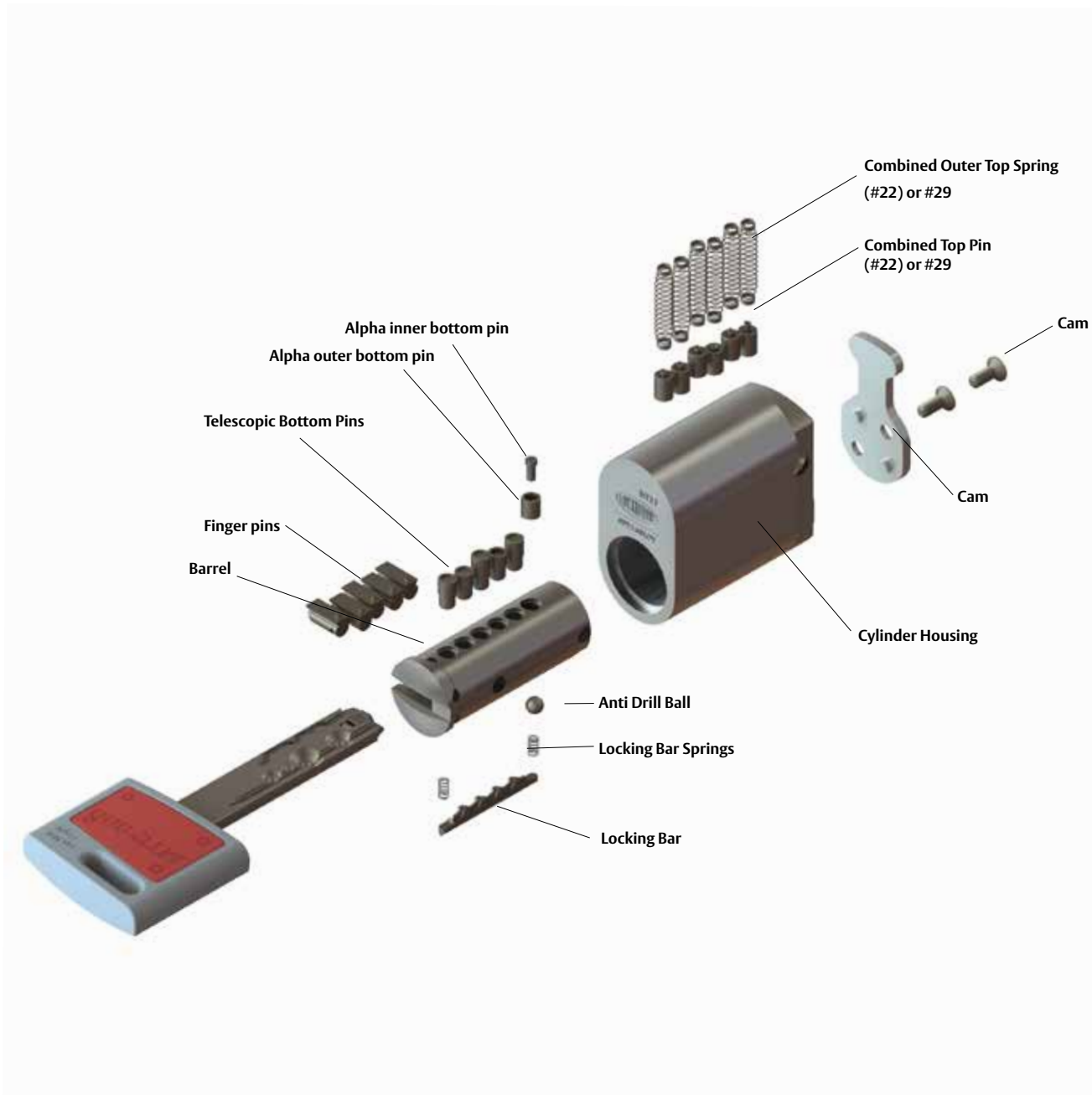

# Master Keying Information

## Special Keying Systems

Most Lockwood locks with pin tumbler cylinders are supplied individually keyed. To provide extra convenience and security, specially keyed systems have been developed to enable the customer to control those locks which an individual is authorised to operate.

A specially keyed system designed to meet your individual requirements can be included in the specification of a new building or can be gradually introduced into an existing complex as old locks are replaced.

Specially keyed systems tend to grow as businesses grow. Therefore, align your keying needs with your projected growth.

Once you install a Lockwood specially keyed system, you open a permanent line of security. Our records enable duplicate keys or additional locks to be supplied with ease and accuracy, but only on receipt of an official order, with all special keying records kept in strictest confidence.

### Keyed to Differ (KD)



With a keyed to differ system, each lock can only be opened by its own individual key. All Lockwood locks are supplied 'keyed to differ' unless a special keying system is requested.

### Keyed Alike System (KA)

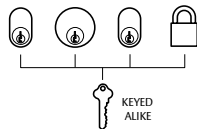

This system allows for a number of locks to be operated by the same key, it is ideally suited to residential applications such as front and back doors. There is no limit to the number of locks which can be keyed alike.

### Master Keyed System (MK)

A Master Keyed System is one where each lock has its own individual key which will not operate any other lock in the system, but where all locks in the system can be operated by one master key.

### Grand Master Keyed System (GMK)

The Grand Master Keyed System is an extension of the Master Keyed System where each lock has its own individual key and the locks are divided into two or more groups. Each group of locks is operated by a master key and the entire system is operated by one grand master key.

### Maison Keyed System (MAIS)

This system is widely used in apartments, flats, office blocks, hotels and motels. Each apartment, flat or office has its own individual key which will not operate the lock to any other apartment, flat, hotel room or office but will operate the locks to communal entry doors and other services areas.

### Construction Keyed System (CK)

A system where it is necessary for contractors to gain entry to a building during construction. Once construction is complete the owners keys will block further access by the contractors.

### Multi-Element Profile Keying System (MEP)

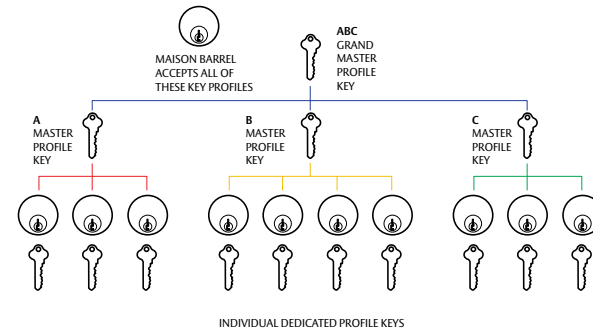

A series of unique element key profiles where each element changes the overall shape of the profile. Each individual profile key will enter a dedicated keyway. The elements of some of these individual profiles in a group can be incorporated in one profile, resulting in a master profile key capable of entering all dedicated keyways in that group. Inclusion of all elements in the profile will result in a unique grand master profile capable of entering all corresponding individual keyways created by the elements in the series.

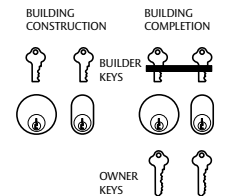
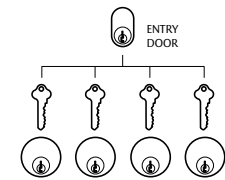
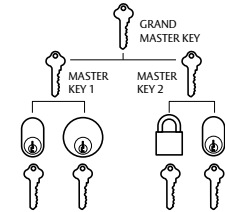
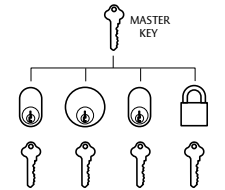

# Overview

The locks, hardware and accessories that you install on your buildings all rely on the integration of the lock cylinder and the key. The lock cylinder and key constitute the keying system. The lock cylinder is central to the lock mechanism installed on your door. This combination controls who is allowed or denied access to the door.

ASSA ABLOY Australia Pty Limited manufacture a range of Lockwood Cylinders to suit residential and commercial applications.

With technological changes in the security industry, you now have a choice of how you wish to secure your premises and control the access throughout the building.

To begin with, you have a choice of a standard pin tumbler mechanism. This is a convenient system available in five and six pin variations and suitable for residential and commercial applications.

The next option is a keying system that incorporates features such as Design Registration and Patent Protection.

Control of the distribution of keys and keyblanks ensures that only authorised companies and individuals can purchase additional keys for your premises. E.g. Lockwood TWIN X®, GEN6TX®, and MTL™800.

Only security professionals who have complied with strict guidelines are able to purchase Lockwood restricted keying system products. These professionals maintain your keying system by verifying that the authority criteria has been met.

Once you have established the type of keying system that suits your needs, you can consult our Special Keying Advisory Service to determine the keying schedule for your building. This may be a Grand Master Key System, a Master Key System or the simplicity of one key convenience for your home.

## Lockwood MTL™800

The Lockwood MTL™800 keying system is a patent protected in Australia until 2039 that combines protective elements to create a triple locking mechanism, superior key control, and extensive master keying capabilities. MTL™800 is backward compatible with MT5+ and MT5 systems.

## Lockwood TWIN X®

TWIN X® is a six pin inline keying system combined with side bar locking feature, that can be maintained by a Lockwood TWIN X® Service Centre, or through our factory. TWIN X® Keys and Barrels are Design registered in Australia and New Zealand.

## Lockwood GEN6TX®

The range of key and barrel profiles in the Lockwood GEN6TX® system are Design Registered in Australia and New Zealand. This is a six pin inline keying system that can be easily transferred and maintained by an authorized Lockwood GEN6TX® Service Centre, or can be maintained through our factory.

## General Keying Profiles

Standard Lockwood cylinders and locks are available to be specially keyed to suit your individual requirements. This allows you to choose the keying access to suit your needs, without restricting access to key cutting.

## The Pin Tumbler Mechanism

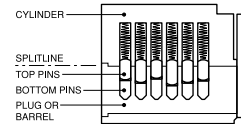

A standard pin tumbler cylinder with the key removed, showing the top pins held in their locking position across the splitline between the plug or barrel and cylinder.

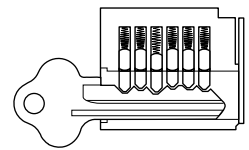

The same cylinder with the correct key inserted, showing pin-breaks aligned with the splitline between the plug or barrel and cylinder, allowing the key to be turned.

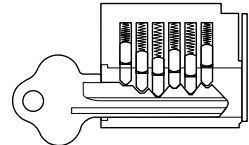

The same cylinder with an incorrect key inserted showing the pin-breaks misaligned with the splitline, preventing the key from being turned.



# Master and General Keying

The MTL™800 locking system from Lockwood provides peace of mind!

To guarantee the technical key security of a mechanical locking system it is necessary to select a system that is protected by key patents and also offers a high technical key copy protection. The new MTL™800 locking system from Lockwood will achieve both of these.

Lockwood MTL™800 provides the highest possible level of protection against illegal key duplication via the revolutionary double

alpha spring. The patented platform combines protective elements to create a triple locking mechanism, superior key control, and extensive master-keying capabilities.

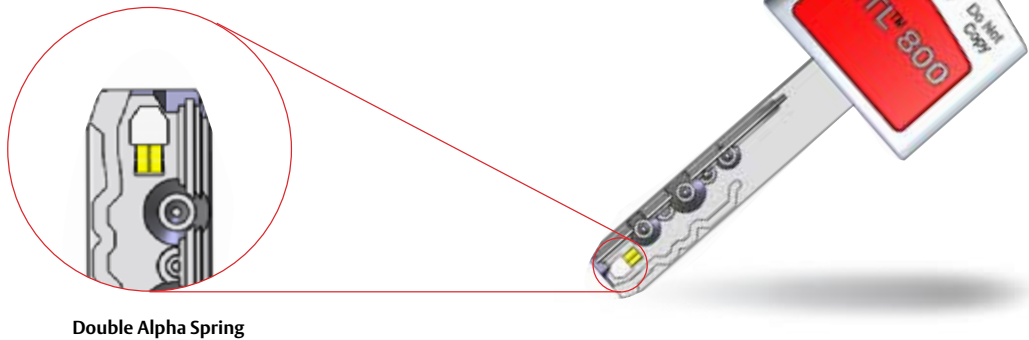

Double Alpha Spring

## 1. Double alpha spring

A patented moving element on the key blade's tip engages with two unique pins at the rear of the cylinder, creating an additional shear line.

## 2. Telescopic pin

Based on Mul-T-Lock's proven telescopic pinning technology.

## 3. Locking bar

The locking bar mechanism is the third technology featured in the MTL™800 and MT5+ cylinders. Correct alignment of the locking bar pins depends upon the correct combination key being inserted into the cylinder. The milled pattern which runs along the length of the key interacts with the top bar and its horizontal pins or also called finger pins, creating the required shear line.

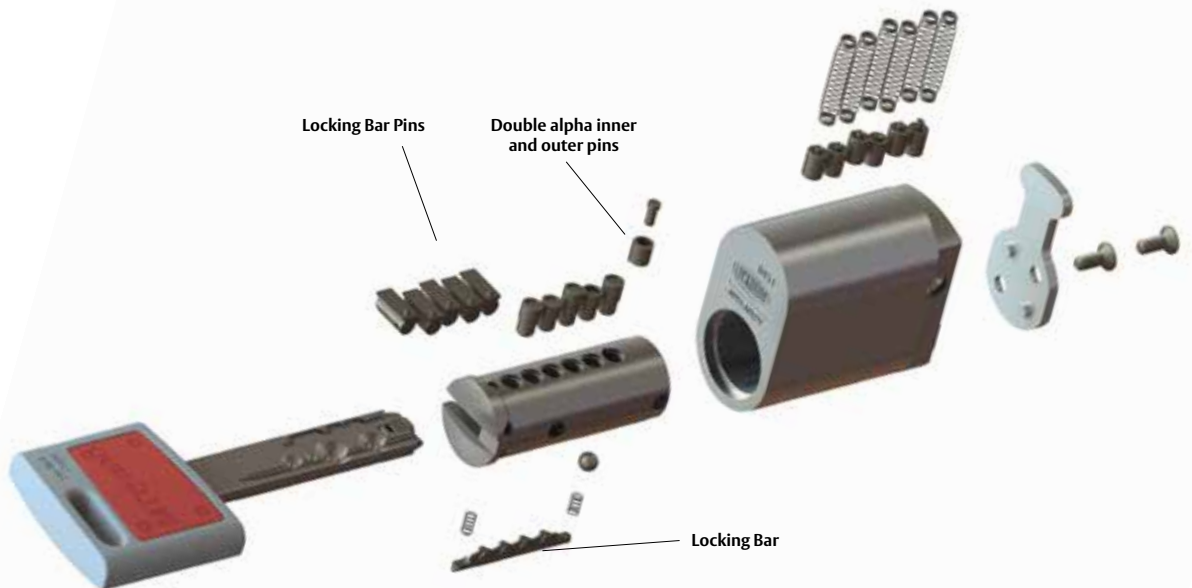

# Master and General Keying

The components of the MTL™800 security system include the MTL™800 key and the MTL™800 KC5 cutting machine.

## MTL™800 key

All MTL™800 products have a double-sided unique MTL™800 key. One set of cuts are for the telescopic pin mechanism and the other set of cuts, the milled pattern, is for the locking bar in MTL™800 products. The MTL™800 combination provides enhanced key security and a higher manipulation resistance.

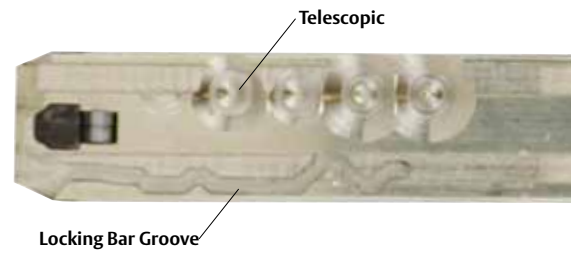

MTL™800 cylinders with reversible key function. The key always fits, regardless of which direction it enters into the cylinder.



The KC5 machine – For a perfect cut key every time!

## The KC5 key cutting machine

Lockwood MTL™800 keys can only be cut through an authorised Lockwood MTL™800 agent on a dedicated Lockwood KC5 key cutting machine. The super smart KC5 machine is electronically controlled and self-calibrating meaning you get a perfect key every time!



# Cylinders



There are numerous MTL™800 cylinder variations available to suit the many different locks available in the Australian market. In pages 8–21 these are shown with detail on dimensions. The diagrams on the following pages have been provided for reference purposes. For simplicity, only assembled cylinders are mentioned on 805 profile.

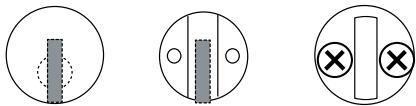



# Contents

201 Rim Cylinder	10
570 Australian Oval Cylinder	11
570E Modular Base Cylinder & 3700 Dual Access Lower Cylinder	12
577 Synergy 3500 Series Dual Access Lower Cylinder	12
334 Padlock Cylinder	13
355 Internal Cylinder	13
530 Key in Knob Cylinder	14
691 Cupboard Lock Cylinder	14
3500 Series Hold Back Cylinders	15
8217 Astra Oval Cylinder	16
8221 "PD" Cylinder	16
8466 Kawneer Cylinder	17
005, Nexion, and Onyx Cylinder	18
Euro Profile Lazy Cam Double Cylinder - suits Security Door locks	19
Euro Profile Lazy Cam Cylinder & Turn - suits Security Door locks	19
Euro Double Cylinder - Fixed Cam	20
Euro Cylinder and Turn - Fixed Cam	20
Euro Single Cylinder - Fixed Cam	21

# Cylinders

## 201 Rim Cylinder

Part Number	Description	SC
201MT5+SC	MT5+ 201 RIM LOCK CYLINDER MK	✓
201M800SC	MTL800 201 RIM LOCK CYLINDER MK	✓

This cylinder is used as the external cylinder in a wide range of rimlocks including Lockwood 001, 002, 303, 355, 201, 211, 213 etc.

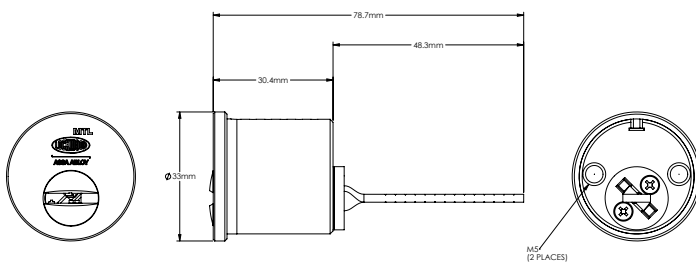

# Cylinders

## 570 Australian Oval Cylinder

Part Number	Description	SC
570MT5+XSC	MT5+ 570 Oval Cylinder with X Cam	✓
570MT5+YSC	MT5+ 570 Oval Cylinder with Y Cam	✓
570MT5+ZSC	MT5+ 570 Oval Cylinder with Z Cam	✓
570MT5+WSC	MT5+ 570 Oval Cylinder with W Cam	✓
570MT5+X7SC	MT5+ 570 Oval Cylinder with X7 Cam	✓
570MT5+VSC	MT5+ 570 Oval Cylinder with V Cam	✓
570MT5+USC	MT5+ 570 Oval Cylinder with U Cam	✓
570MT5+MSC	MT5+ 570 Oval Cylinder with M Cam	✓
590MT5+RSC	MT5+ 570 Oval Cylinder with R Cam	✓
570M800XSC	MTL800 570 Oval Cylinder with X Cam	✓
570M800YSC	MTL800 570 Oval Cylinder with Y Cam	✓
570M800ZSC	MTL800 570 Oval Cylinder with Z Cam	✓
570M800WSC	MTL800 570 Oval Cylinder with W Cam	✓
570M800X7SC	MTL800 570 Oval Cylinder with X7 Cam	✓
570M800VSC	MTL800 570 Oval Cylinder with V Cam	✓
570M800USC	MTL800 570 Oval Cylinder with U Cam	✓
570M800MSC	MTL800 570 Oval Cylinder with M Cam	✓
590M800RSC	MTL800 570 Oval Cylinder with R Cam	✓

This cylinder is used on Lockwood Cylinder Mortice Locks such as the 3770 Series and 3570 Series (3772, 3572 etc.), 3780 and 3580 Series (3782, 3582 etc.). The lock application and function is dependant on the various cylinder cams shown below.

Various extended length cylinders are also available.

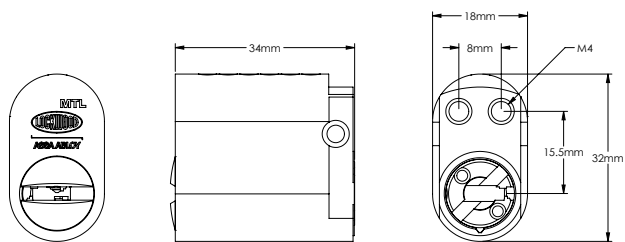

### Standard Cams

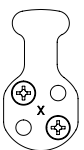

CM15/C570X  
"X" Cam

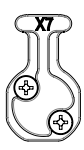

CM15/C570X7  
"X7" Cam



CM15/C570Y  
"Y" Cam

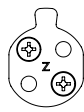

CM15/C570Z  
"Z" Cam

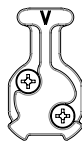

CM15/C570V  
"V" Cam



CM15/C570W  
"W" Cam



CM15/C570W  
upside down "W" Cam



CM15/C590R  
"R" Cam

# Cylinders

## 570E Modular Base Cylinder & 3700 Dual Access Lower Cylinder

Part Number	Description	SC
570EMT5+77SC	MT5+ 3777 Dual Access Lower Cylinder	✓
570EMT5+###	MT5+ 570E Modular base Cylinder, length extendable based on requirement	✓
570EM80077SC	MTL800 3777 Dual Access Lower Cylinder	✓
570EM800##	MTL800 570E Modular base Cylinder, length extendable based on requirement	✓

This cylinder is used in bottom cylinder in the Lockwood 3700 Series Dual Entry Mortice Lock.

Extended cylinders are often required where a door thickness of 50mm or greater, or when the mortice lock is mounted off centre in the door. Virtually any length cylinder can be made by stacking as many. There are three different size extension kits. They come in 7mm, 10mm and 24mm sizes.

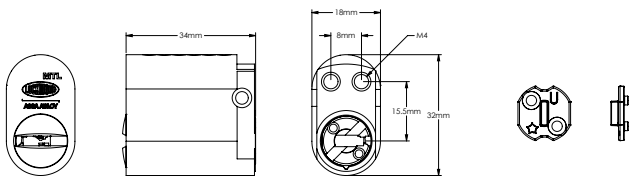

### Extension Kits

Part Number	Pack Size	Description
570/EXT07	5	7mm Extension Kit
570/EXT10	5	10mm Extension Kit
570/EXT24	5	24mm Extension Kit

Extended Cylinder Base

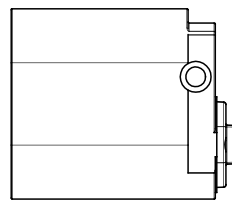

Part No. 570/EXT10

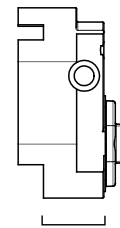

10mm Extension

Part No. 570/EXT07

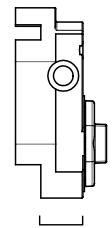

7mm Extension

## 577 Synergy 3500 Series Dual Access Lower Cylinder

Part Number	Description	SC
577MT5+SC	MT5+ 577 Dual Access lower Cylinder	✓
577M800SC	MTL800 577 Dual Access lower Cylinder	✓

This cylinder is used as the bottom cylinder in the Lockwood 3577 Dual Entry Mortice Lock.

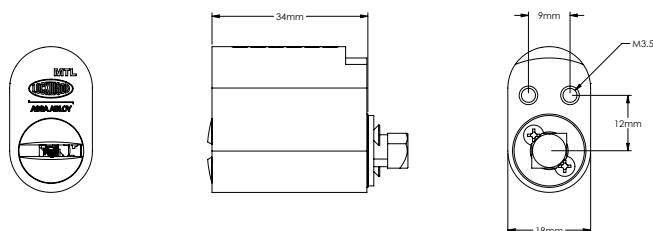

3777 Spindle Cam  
CMT5/C577

# Cylinders

## 334 Padlock Cylinder

Part Number	Description	SC
334MT5+SC	MT5+ 334B Padlock Cylinder	✓
334M800SC	MTL800 334B Padlock Cylinder	✓

This cylinder is used for the Lockwood 334 range of padlocks and various other re-keyable padlocks.

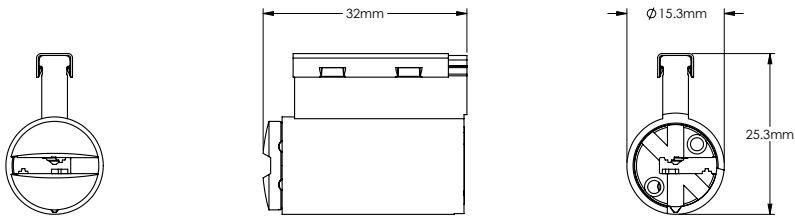

## 355 Internal Cylinder

Part Number	Description	SC
355MT5+SC	MT5+ 355 Inner Cylinder with Cam	✓
355M800SC	MTL800 355 Inner Cylinder with Cam	✓

This cylinder is used for the inside of the Lockwood 355 Deadlock.

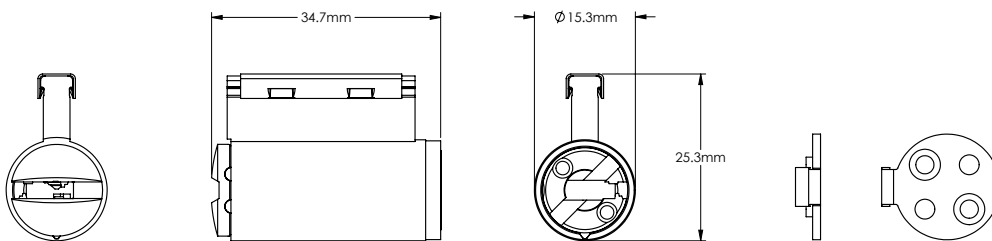

# Cylinders

## 530 Key in Knob Cylinder

Part Number	Description	SC
530MT5+SC	MT5+ 530 Cylinder	✓
530M800SC	MTL800 530 Cylinder	✓

This cylinder is used in the Lockwood 530 Series Key in Knob Locksets and the 930/950 Series Key in Lever Locksets.

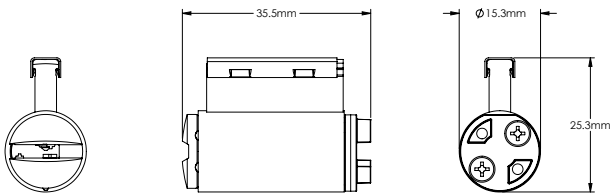

## 691 Cupboard Lock Cylinder

Part Number	Description	SC
691MT5+SC	MT5+ 691 Cupboard Lock Cylinder	✓
691M800C	MTL800 691 Cupboard Lock Cylinder	✓

This cylinder is used in the 693 cupboard lock range.

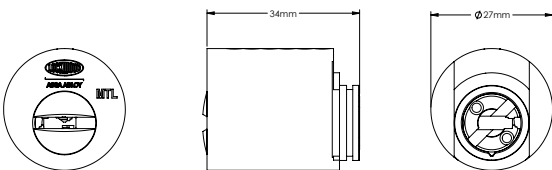

# Cylinders

## 3500 Series Hold Back Cylinders

Part Number	Description	SC
570EMT5+7L/40SC	MT5+ 3570 Synergy Hold Back Cylinder L/Hand	✓
570EMT5+7R/40SC	MT5+ 3570 Synergy Hold Back Cylinder R/Hand	✓
570EMT5+8R/40SC	MT5+ 3580 Synergy Hold Back Cylinder R/Hand	✓
570EM8007L/40SC	MTL800 3570 Synergy Hold Back Cylinder L/Hand	✓
570EM8007R/40SC	MTL800 3570 Synergy Hold Back Cylinder R/Hand	✓
570EM8008R/40SC	MTL800 3580 Synergy Hold Back Cylinder R/Hand	✓

**NOTE:** A hold back adaptor is available to suit MT5 Modular Base Cylinders

This cylinder is used as the holdback cylinder for Lockwood Synergy 3500 Series Mortice Locks

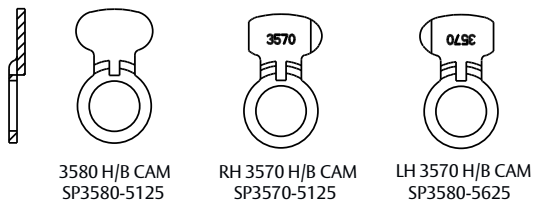
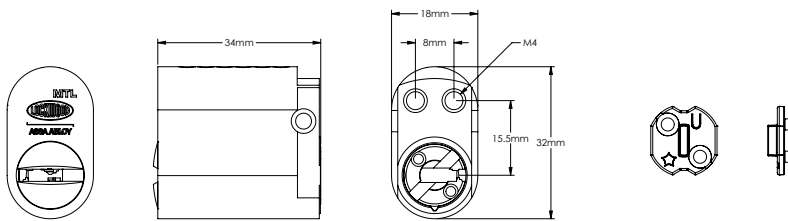

# Cylinders

## 8217 Astra Oval Cylinder

Part Number	Description	SC
8217MT5+SC	MT5+ Astra Oval with Standard Cam	✓
8217M800SC	MTL800 Astra Oval with standard cam	✓

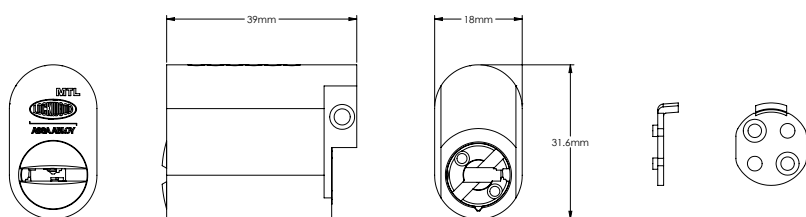

## 8221 "PD" Cylinder

Part Number	Description
8221MT5+SC	MT5+ PD Cylinder (KNK) * Use Existing Cam from Lock
8221M800SC	MTL800 Cylinder (KNK) * Use Existing Cam from Lock

This cylinder is used in Lockwood 7105 and 7108 Symmetry Deadbolts, Yale Commercial Key in Knob Locksets, and the outside of the Lockwood Onyx Sliding Patio Door Lock. Also used in many other imported locksets.

Various tail pieces can be fitted to this cylinder. Due to the variety available the tail piece from the existing lockset will be required to be fitted to this cylinder.

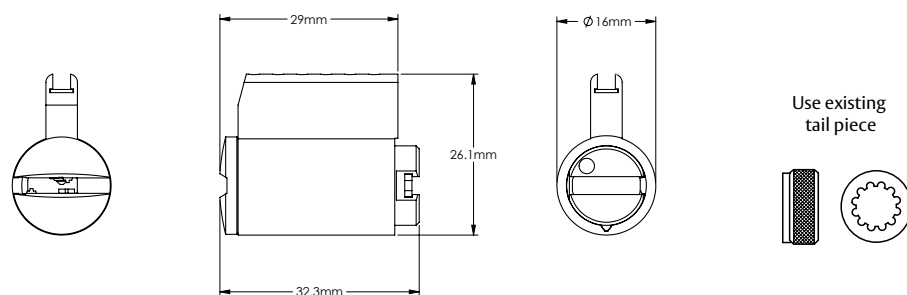



# Cylinders

## 8466 Kawneer Cylinder

Part Number	Description
8466MT5+SC	Kawneer Cylinder with 8466-18 Cam
8466M800SC	MTL800 Kawneer Cylinder with 8466-18 Cam

This cylinder is used in many imported locks. The cylinder is screwed into the mortice lock and then retained by a grub screw. It is important to check the thread pitch for compatibility. This cylinder comes with the 8466-18 Deadlocking Cam. Other cams are available separately.

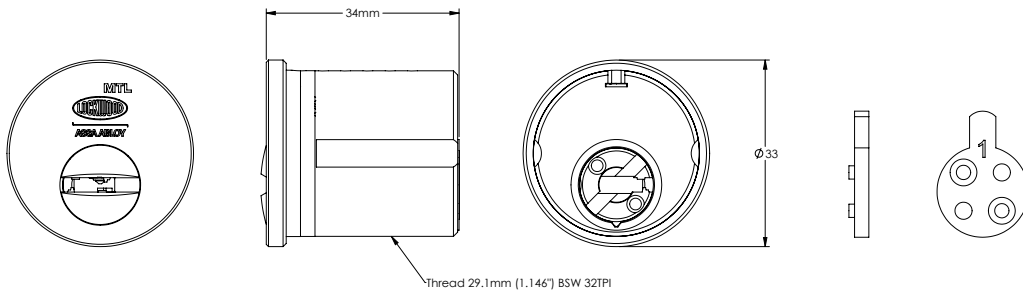

# Cylinders

## 005, Nexion, and Onyx Cylinder

Part Number	Description
005MT5+SC	Paradigm Single Cylinder with Paradigm Cam (Internal or External)
NEXMT5+ESC	Nexion External Cylinder with Nexion Cam
NEXMT5+ISC	Nexion Internal Cylinder with Nexion Cam
ONYMT5+ESC	MT5+ ONYX Cylinder with External cam (Tailbar and cylinder cap)
ONYMT5+ISC	MT5+ ONYX Cylinder with Internal cam
005M800SC	MTL800 Paradigm Single Cylinder with Paradigm Cam (005 Cam)
NEXM800ESC	MTL800 Nexion External Cylinder with Nexion EXTERNAL Cam
NEXM800ISC	MTL800 ONYX Cylinder with External cam (Tailbar and cylinder cap)
ONYM800ESC	Nexion Internal Cylinder with Nexion Cam
ONYM800ISC	MTL800 ONYX Cylinder with Internal cam

These cylinders are used in Lockwood 005 Paradigm Deadbolt, Nexion Locksets and

the inside on the Onyx Sliding Patio Door Lock. The lock application and function is dependant on the various cylinder cams shown below.

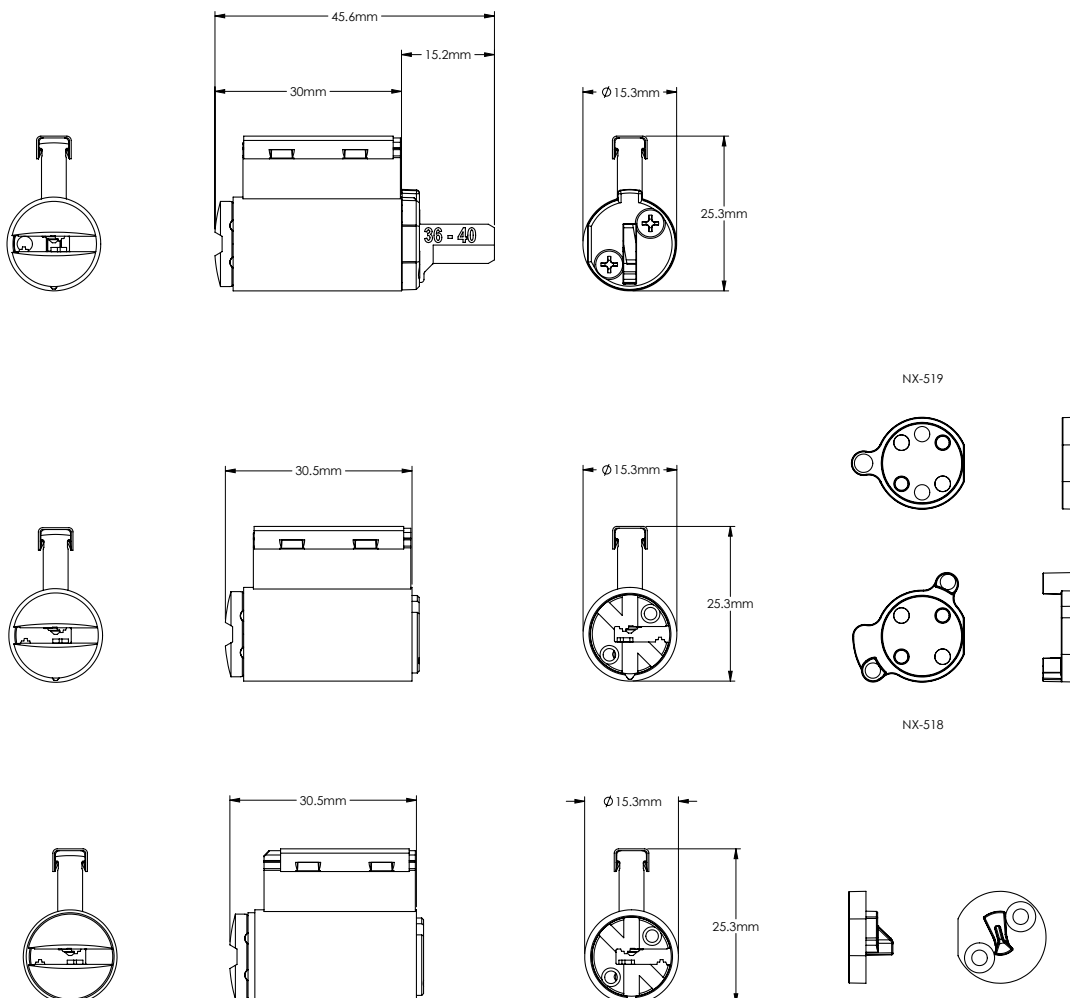

# Cylinders

## Euro Profile Lazy Cam Double Cylinder - suits Security Door locks

Part Number	Description	CP
EURMT5/LDCP	MT5+ Double Euro Cylinder with Lazy Cam	✓
EURM800/LDCP	MTL800 Double Euro Cylinder with Lazy Cam	✓

Used in various security door locks including Lockwood 8653, Whitco Tasman and Leichhardt Locksets. Retainer screw is 3/16" BSW thread and 32mm long.

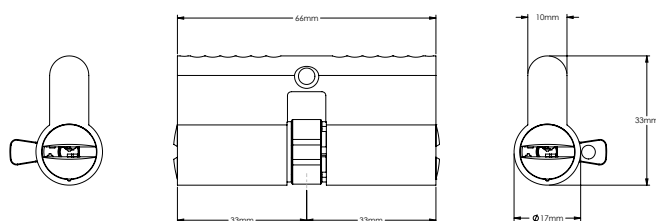

## Euro Profile Lazy Cam Cylinder & Turn - suits Security Door locks

Part Number	Description	CP
EURMT5+LLTCP	MT5+ Cylinder and Turn Euro with Lazy Cam L/H	✓
EURMT5+LRTCP	MT5+ Cylinder and Turn Euro with Lazy Cam R/H	✓
EURMT5/LDCP	MTL800 Cylinder and Turn Euro with Lazy Cam L/H	✓
EURM800LRTCP	MTL800 Cylinder and Turn Euro with Lazy Cam R/H	✓

Used in various security door locks including Lockwood 8653, Whitco Tasman and Leichhardt Locksets. Retainer screw is 3/16" BSW thread and 32mm long.

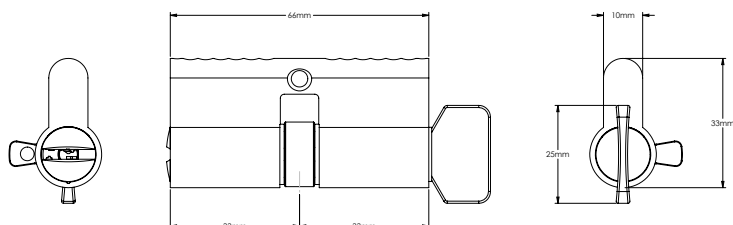

# Cylinders

## Euro Double Cylinder - Fixed Cam

Part Number	Description	CP
EURMT5+FDPCP	MT5+ Double Cylinder Euro with Fix Cam	✓
EURM800FDPCP	MTL800 Double Cylinder Euro with Fix Cam	✓

Used in many Euro style mortice locks including Lockwood Optimum and Defender Mortice Locks. Retainer screw is M5 thread.

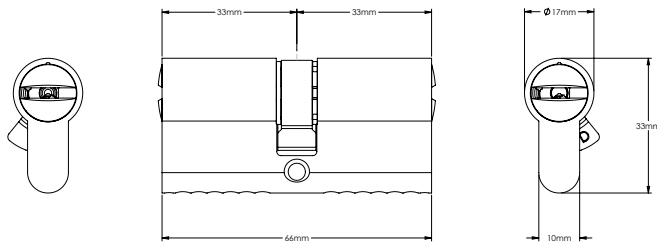

## Euro Cylinder and Turn - Fixed Cam

Part Number	Description	CP
EURMT5+FTCP	MT5+ Cylinder and Turn Euro with Fix Cam	✓
EURM800FTCP	MTTL800 Cylinder and Turn Euro with Fix Cam	✓

Used in many Euro style mortice locks including Lockwood Optimum and Defender Mortice Locks. Retainer screw is M5 thread.

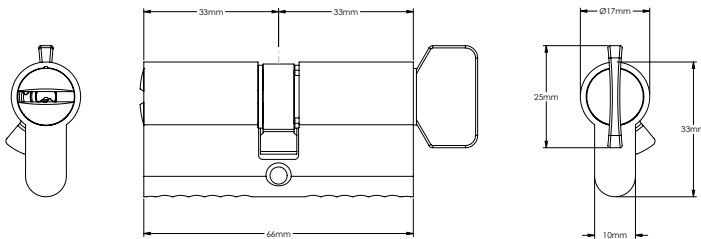

# Cylinders

## Euro Single Cylinder - Fixed Cam

Part Number	Description	CP
EURMT5+FSCP	MT5+ Single Cylinder Euro with Fix Cam	✓
EURM800FSCP	MTL800 Single Cylinder Euro with Fix Cam	✓

Used in many Euro style mortice locks including Lockwood Optimum and Defender Mortice Locks. Retainer screw is M5 thread.

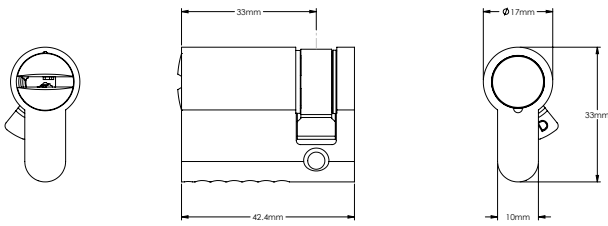

# Modular Cylinder Extensions



The Lockwood's Modular Cylinder Extensions provide a simple and effective method of producing an extended cylinder. The onsite flexibility of this solution will save both time and money in all applications where extended cylinders are required.

Extended cylinders are often required where a door thickness of 50mm or greater, or when the mortice lock is mounted off centre in the door. The extra length in the cylinder is required to bring the face of the cylinder out from the door and escutcheon to enable use of the key.

Virtually any length cylinder can be made by stacking as many or as few extension pieces as required together and screwing them into the back of a special extended cylinder base.

The desired cam required for the special lock function is attached to the end of the extended cylinder and then it is ready for installation.

## Cylinder

A special extended base cylinder is required as it has two tapped holes in the back of the cylinder to accept the assembly screws to retain the extension kits. These cylinders use the standard 570 type barrel. These

extended base cylinders are available in standard and Lockwood MT5+® Keying Systems with a universal barrel adaptor to drive the barrel extensions found in the extension kits.

## Extension Kits

There are three different size extension kits that can be mixed and matched with the extended cylinder base to make up the desired length cylinder. They come in 7mm, 10mm and 24mm sizes. Each kit comes complete with the cylinder extension, barrel extension and universal barrel adaptor screwed to the barrel extension. Once the cylinder is assembled the rear barrel adaptor is removed and the standard locking cam (X, Z, Y, etc.) is fitted to operate the mortice lock.

## Assembly Screws

There are four lengths of assembly screws that are available to hold the extension kit/s to the extended base cylinder, depending on the overall length required.

## How to Order

You will need to order the extended base cylinder (in the required keying system), the extension kit or kits needed to make up the cylinder length and the assembly screws to hold the extension kits to the extended base cylinder. The end cam will then need to be changed for the required cam needed for the function of the mortice lock.

# Modular Cylinder Extensions

## Screws

Part Number	Pack Size	Length (B)	Min – Max Extension (mm) If screw uncut
SRWM4-32SS	10	32	7 – 24
SRWM4-42SS	10	42	14 – 36
SRWAM4-65SS	10	65	37 – 58
SRWAM4-75SS	10	75	47 – 68

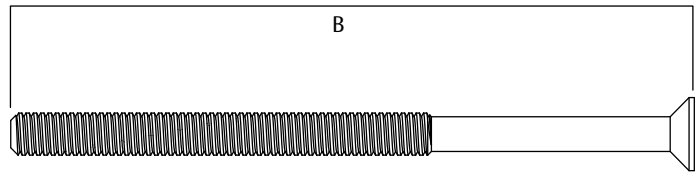

Screws are available in following sizes which can be cut and deburred to the desired length.

## Cylinder Extension Guide

Overall Cylinder Length Required	Cylinder Projection (A)*	Door Thickness	Extended Base Cylinder	7mm Extension Kit	10mm Extension Kit	24mm Extension Kit	32mm Assembly Screw	42mm Assembly Screw	65mm Assembly Screw
34	37	35	49			Standard Mortice Cylinder			
41	44	49	63	1	1		2		
50	54	63	83	1	1	1	2		
61	64	83	103	1	1	2		2	
65	68	93	98	1	1		1	2	
72	75	103	123	1	2		1		2
82	85	123	143	1			2		2
92	95	143	163	1		1	2		2

\*Cylinder projection is based Selector Series Mortice Lock, Synergy Series Mortice lock projections are 1 mm less.

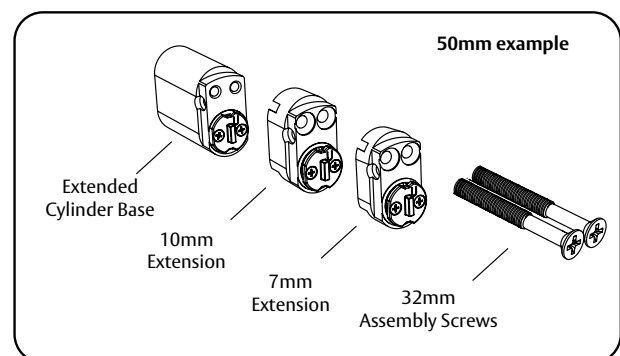
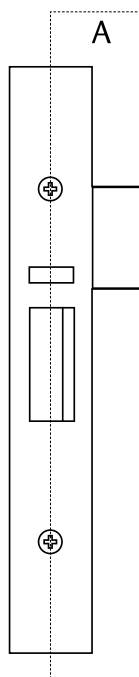

## Extension Kits

Part Number	Pack Size	Description
570/EXT07	5	7mm Extension Kit
570/EXT10	5	10mm Extension Kit
570/EXT24	5	24mm Extension Kit



Lockwood is the leading brand in the Australian locking industry. With an established reputation for high quality products, this iconic brand provides a wide range of locking solutions to residential housing, commercial building and industrial application markets. Lockwood is supported by an extensive distribution and after-sales support network. Our customers include retailers, architects, trade and industrial personnel, locksmiths and security dealers.

ASSA ABLOY is the global leader in door opening solutions, dedicated to satisfying end-user needs for security, safety and convenience.

ASSA ABLOY is represented in all major regions, in both mature and emerging markets, with leading positions in Australia, Europe and North America.



#### The Lockwood 25 Year Mechanical Warranty

Our belief that we manufacture the finest premium products available in today's market place is backed by the Lockwood 25 Year Mechanical Warranty, ensuring that Lockwood continues to keep Australians safe by delivering security and peace of mind.

For warranty terms and conditions, please visit [www.lockweb.com.au](http://www.lockweb.com.au) or call 1300WARRANTY

**ASSA ABLOY Australia Pty Ltd**  
235 Huntingdale Road  
Oakleigh, Victoria, 3166  
Australia

**1300 LOCK UP (1300 562 587)**  
[lockweb.com.au](http://lockweb.com.au)

**ASSA ABLOY New Zealand Ltd**  
6 Armstrong Road  
Albany, Auckland, 0632  
New Zealand

**[info.nz@assaabloy.com](mailto:info.nz@assaabloy.com)**  
**Telephone +64 9415 7111**  
**[assaabloy.co.nz](http://assaabloy.co.nz)**

#### Disclaimer

Whilst every effort has been made to ensure that the information (including product images and drawings) contained in this brochure is accurate at the time of publication, ASSA ABLOY Australia Pty Limited ("ASSA ABLOY") recommends that you consult ASSA ABLOY or its agents prior to placing an order to ascertain current information on specific products, as ASSA ABLOY reserves the right to make changes without notice. ASSA ABLOY will not be liable for any injury, loss or damage whatsoever, arising from any errors or omissions in the information contained in the brochure or arising from the use or application of the information contained herein. © 2024 copyright by ASSA ABLOY All rights reserved